

seppi m[®]

MULCHING EQUIPMENT SPECIALISTS

Flail Mulchers
SMW · SMO

Flail Mulchers

20-120 HP



seppi m.

MULCHING EQUIPMENT SPECIALISTS



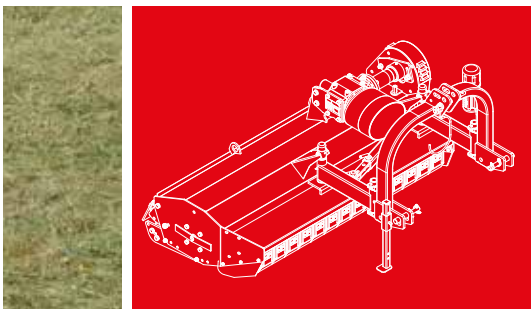
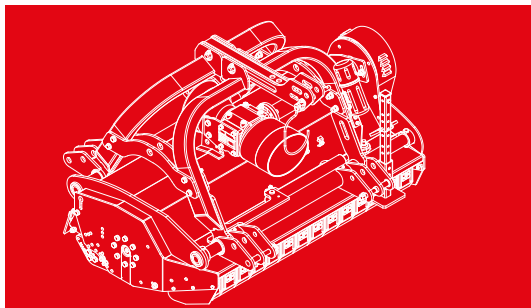
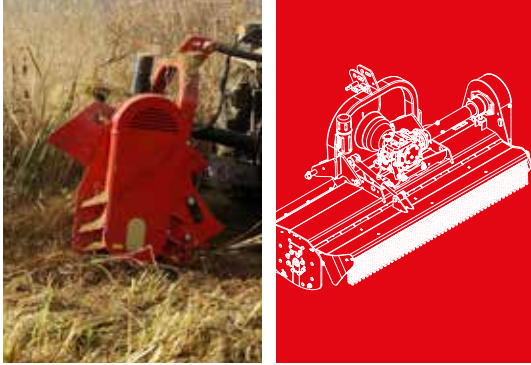

SEPPi M. Professional Flail Mulchers

Since 1971 SEPPi flail mowers have been working to satisfy professionals in agriculture and greenspace maintenance.

Strength and reliable performance, both in grass and wood, saves time and costs compared to less professional machines.

With a vast range of options and accessories, every machine can be equipped to meet specific professional needs, individual requirements or working conditions.

"Mulchers are a long-term investment.
It is important to us that you remain satisfied with your mulcher."

SEPPI M. SpA

Our Commitment

- > Founded in 1939, we have specialized in manufacturing mulchers since 1971
- > Regardless of the manufacturer or brand, we only choose materials and products that meet our rigorous quality criteria
- > Continuous research and development
- > High quality and optimal service

Your Advantages

- > Reliable equipment as the result of years of experience in the sector
- > High quality materials to take on the harshest work conditions and guarantee maximum durability
- > Advanced technology for an investment for the future
- > Consulting and after sales service: You can rely on us!

Rotors and Tools

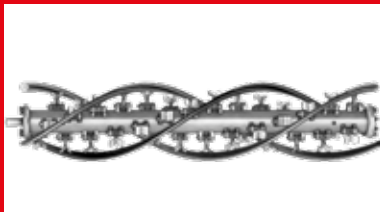

Triple helical rotor
> better power distribution, low noise and vibration.
Holders made of forged and tempered steel,
high strength screws and heads
> ensures high wear resistance.



Rotor with powerful flails for mulching grass and brush,
made of forged steel >self-sharpening and wear-resistant.



Rotor with a large number of Y-blades
for mulching grass and brushwood.



Forestry rotor with swinging or fixed hammers with carbide inserts,
for mulching brush and wood.



Flail Mulchers 20-120 HP

Find the machine according to your application here.

The following mulchers are designed for tractors with a nominal power of 20-120 HP.

They mulch grass and prunings up to 7 cm in diameter.

Mulchers for 80-250 HP tractors and applications for material up to 11 cm in diameter are compiled in a separate brochure.

Versatility of SEPPi M. flail mulchers



Open rear hood:
to mulch grass with low power consumption

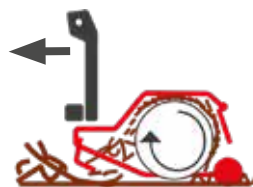

Closed rear hood:
for fine mulching prunings and brushes

WORKING WIDTH cm [inch]											MODEL · WEIGHT ¹ · TRACTOR ²				
95	105	115	125	135	145	155	175	200	225	250	275	linkage	side shift	tools	Ø max
[37	41	45	49	53	57	59	61	69	79	89	108	rear	-		3 cm [1.2"]
•	•	•	•	•	•	•	•	•	•	•	•	reversible	manual 2 positions		5 cm [2"]
•	•	•	•	•	•	•	•	•	•	•	•	reversible	linear hydraulic		5 cm [2"]
			•	•	•	•	•	•	•	•	•	reversible	linear hydraulic		5 cm [2"]
		•				•	•	•	•	•	•	front/push	-		5 cm [2"] 12 cm [5"]
			•	•	•	•	•	•	•	•	•	rear	parallel/manual to the right option: hydraulic		5 cm [2"]
	•			•	•	•	•	•	•	•	•	rear	parallel/manual to the right or left option: hydraulic		7 cm [2.8"]
					•	•	•	•	•	•	•	reversible	-		7 cm [2.8"]
					•	•	•	•	•	•	•	reversible	linear hydraulic		7 cm [2.8"]

¹ standard version without options

² tractor nominal power

X-FAST

Attachments: XSC · XSA · XSP · XDF · XAN · XID

Equipment for undercanopy maintenance (optional accessories)

In order to keep the orchards clean, SEPPI M. offers a spraying system as well as several mechanical attachments for organic farming. The accessories are connected to the mulcher with the quick coupling system X-FAST.

The several equipments and their use are listed below.

Attachments with quick coupling system

- > The **outrigger XSC** is specialized for inter-row mowing. The double XSC outrigger also adapts to row widths. This makes mowing much faster and more efficient.
- > The **cultivator XSA** supports organic agriculture. A mechanical process cuts the roots of weeds and brings them to the surface.
- > The brushes of the **shoot removers XSP and XDF** clean the trunk and remove shoot, suckers and straw mechanically – without chemicals.

Other accessories for undercanopy maintenance

- > The **sweeper XAN** collects leaves and prunings from row sides and bring them into an ideal position for mulching: in front of the mulching mower.
- > The **herbicide spraying system XID** can be mounted to a SEPPI mulcher or a rotary mower. High-precision nozzles come with adjustable spraying direction.



For details, refer to the brochure "Equipment for Undercanopy Maintenance".



 www.youtube.com/seppimulcher

SML

20-50 HP Ø max. 3 cm [1.2 inch]

Lightweight mulcher for light tractors

The SML flail mower is ideal for low nominal power tractors. Several options are available for the machine, guaranteeing a perfect result, whatever the conditions.



Standard version and characteristics

- > Mulches grass and brush up to 3 cm [1.2"]Ø

- > Working speed 3-10 km/h

- > 3 point rear linkage cat. 1&2 central fixed

- > 540 rpm gearbox with freewheel

- > Belt transmission

- > Front protection: metal flaps

- > Rear protection: rubber flap

- > Support roller 133 mm [52"] Ø

- > Standard rotor with SMW flails optionally with Y flails

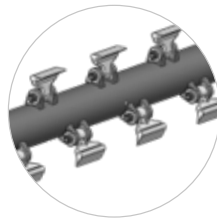

Standard rotor with SMW flails

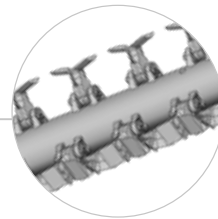

Optional rotor with Y flails

Height-adjustable support roller

Metal flaps in the front and rubber protection in the back protect tractor and driver

Specifications · SML

		105 [41]	125 [49]	155 [61]	175 [69]	200 [79]
Working width	cm [inch]	105 [41]	125 [49]	155 [61]	175 [69]	200 [79]
Overall width	cm [inch]	125 [49]	145 [57]	175 [69]	195 [77]	220 [87]
Depth	cm [inch]	90 [35]	90 [35]	90 [35]	90 [35]	90 [35]
Height	cm [inch]	95 [37]	95 [37]	95 [37]	95 [37]	95 [37]
Weight (base value)	kg [lb]	265 [580]	290 [640]	330 [720]	350 [770]	380 [840]
Belts	qty	3	3	3	3	3
Flails	qty	9	12	15	18	21
Y flails	qty	18	24	27	33	39
Nominal tractor power	HP	20-50	20-50	20-50	20-50	20-50

Tools



SMWA rev cf

30-90 HP Ø max. 5 cm [2 inch]

Reversible linkage for front and rear

Agriculture or greenspace maintenance? All easy ...
– the mulchers of the SMW series mulch grass, prunings and bushes up to 5 cm [2"] in diameter.

The SMWA rev cf standard version has manual side shift with a two position bolt-on hitch: central and 17 cm [6.7"] to the right.

Standard version and characteristics

- > Mulches grass and brush up to 5 cm [2"]Ø
- > Working speed 3-10 km/h
- > 3 point linkage cat. 1&2 reversible
- > Side shift with 2 positions: central and 17 cm [6.7"] to the right
- > 540 rpm gearbox with freewheel and through shaft
- > Belt transmission
- > Adjustable rear hood with rubber protection
- > Front protection with metal flaps
- > Support roller 152 mm Ø
- > Standard rotor with SMW flails

Optional configuration and accessories

- > Rotor with Y flails
- > 750 or 1000 rpm gearbox
- > Gearbox with automatic inverter and double freewheel
- > Additional 3-point linkage
- > Front attachment
- > Hood with rakes
- > Metal front wheels
- > Front protection with chains instead of metal flaps
- > Additional front rubber flap
- > Attachments for undercanopy maintenance (details see separate brochure)



[YouTube www.youtube.com/seppimulcher](https://www.youtube.com/seppimulcher)

Tools



Flails
SMW



Flails
Y DUO

Specifications · SMWA rev cf

		95 [37]	105 [41]	115 [45]	125 [49]	135 [53]	145 [57]	155 [61]	175 [69]	200 [79]	225 [89]
Working width	cm [inch]	95 [37]	105 [41]	115 [45]	125 [49]	135 [53]	145 [57]	155 [61]	175 [69]	200 [79]	225 [89]
Overall width	cm [inch]	107 [42]	117 [46]	127 [50]	137 [54]	147 [58]	157 [62]	167 [66]	187 [74]	212 [84]	237 [93]
Depth	cm [inch]	90 [35]	90 [35]	90 [35]	90 [35]	90 [35]	90 [35]	90 [35]	90 [35]	90 [35]	90 [35]
Height	cm [inch]	95 [37]	95 [37]	95 [37]	95 [37]	95 [37]	95 [37]	95 [37]	95 [37]	95 [37]	95 [37]
Weight (base value)	kg [lb]	315 [690]	335 [740]	345 [760]	355 [780]	385 [850]	415 [910]	465 [1030]	485 [1070]	515 [1140]	535 [1180]
Belts	qty	3	3	3	3	3	3	3	4	4	4
Flails	qty	9	9	12	12	12	15	15	18	21	24
Y flails	qty	15	18	21	24	24	27	27	33	39	45
Nominal tractor power	HP	30-65	30-65	30-65	30-65	30-65	30-65	30-65	40-90	40-90	40-90

SMWA rev cf · features

Robust double wall chassis made of high tensile steel S420.



side shift:
manual by 2 positions
17 cm [6.7 inch]

Adjustable hood
to set the degree of mulching

Support roller, adjustable in height
Reinforced bearing and roller

Standard rotor
with SMW flails

Optional rotor
with Y flails

Tempered counter
knives for a perfect
mulching result

Gearbox for
front and rear attachment

Metal front wheels
(option)

SMWA s

30-90 HP Ø max. 5 cm [2 inch]

Reversible linkage and hydraulic side shift

Agriculture or greenspace maintenance? All easy ...
– the mulchers of the SMW series mulch grass, prunings and bushes up to 5 cm [2"] in diameter.

The SMWA s can be shifted to the right up to a maximum of 27 cm [10.6"]. The side shift is linear and works even while the machine is mowing, with hydraulic control from the tractor seat.

Standard version and characteristics

- > Mulches grass and brush up to 5 cm [2"]Ø
- > Working speed 3-10 km/h
- > 3 point linkage cat. 1&2 reversible
- > Linear hydraulic side shift 27 cm [10.6"]
- > 540 rpm gearbox with freewheel and through shaft
- > Belt transmission
- > Adjustable rear hood with rubber protection
- > Front protection with metal flaps
- > Support roller 152 mm Ø
- > Standard rotor with SMW flails

Optional configuration and accessories

- > Rotor with Y flails
- > 750 or 1000 rpm gearbox
- > Gearbox with automatic inverter and double freewheel
- > Additional 3-point linkage
- > Front attachment
- > Hood with rakes
- > Metal front wheels
- > Front protection with chains instead of metal flaps
- > Additional front rubber flap



www.youtube.com/seppimulcher

Tools



Specifications · SMWAs

		105 [41]	115 [45]	125 [49]	135 [53]	145 [57]	155 [61]	175 [69]	200 [79]
Working width	cm [inch]	105 [41]	115 [45]	125 [49]	135 [53]	145 [57]	155 [61]	175 [69]	200 [79]
Overall width	cm [inch]	117 [46]	127 [50]	137 [54]	147 [58]	157 [62]	167 [66]	187 [74]	212 [84]
Depth	cm [inch]	90 [35]	90 [35]	90 [35]	90 [35]	90 [35]	90 [35]	90 [35]	90 [35]
Height	cm [inch]	105 [41]	105 [41]	105 [41]	105 [41]	105 [41]	105 [41]	105 [41]	105 [41]
Weight (base value)	kg [lb]	360 [790]	380 [830]	390 [850]	420 [920]	440 [960]	455 [970]	505 [1110]	530 [1180]
Belts	qty	3	3	3	3	3	3	4	4
Flails	qty	9	12	12	12	15	15	18	21
Y flails	qty	18	21	24	24	27	27	33	39
Nominal tractor power	HP	30-65	30-65	30-65	30-65	30-65	30-65	40-90	40-90



SMWA s · features

Robust double wall chassis made of high tensile steel S420.

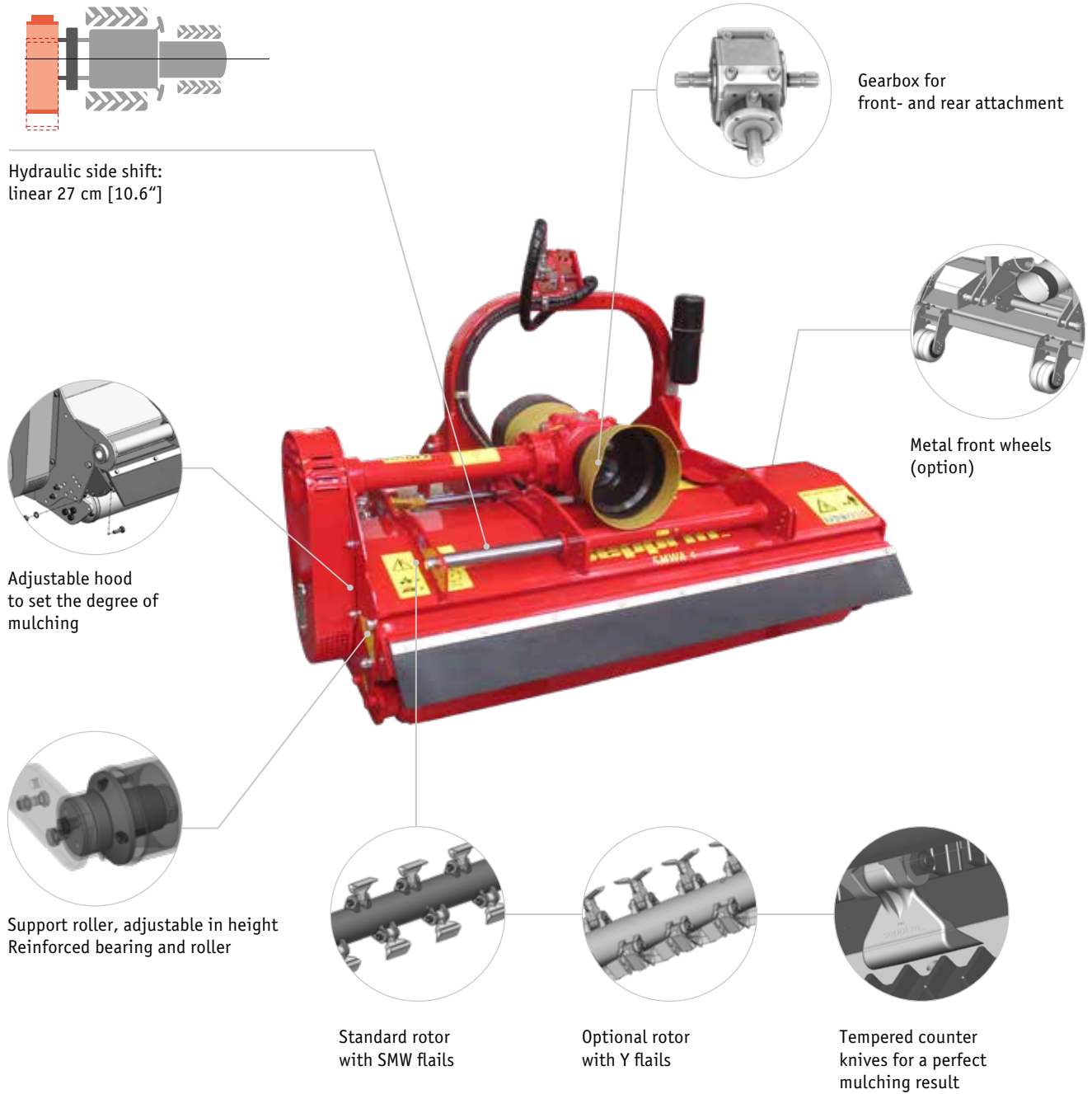



SMWA slim · features

Robust double wall chassis made of high tensile steel S420.

Gearbox for front- and rear attachment

Hydraulic side shift - linear right/left
2 x 13.5 cm = 27 cm
[2 x 5 inch = 10 inch]

Rotor with SMW flails

Tempered counter knives for a perfect mulching result

Adjustable hood to set the degree of mulching

Support roller, adjustable in height
Reinforced bearing and roller

The power belt chassis is very compact - this allows the machine to work close to the crop

S5 cabrio

30-90 HP Ø max. 5/12 cm [2/5 inches]

Lightweight powerhouse - reliable for use as a high-grass mulcher

With a double skin casing made of wear resistant steel, the S5 cabrio is a perfect mulcher for exacting conditions. The lightweight construction allows work on sloping ground. With a manual inverter the mulching result can be optimized.

Depending on the direction of the rotor shaft it mulches low or high grass and brush.

Standard version and characteristics

- > Mulches grass and brush up to 5 cm [2"]Ø

- > Working speed 3-10 km/h

- > 3 point linkage cat. 1&2 front attachment or push

- > 540 rpm gearbox without freewheel with manual inverter

- > STOPSAFE™ System

- > Belt transmission

- > Hydraulic adjustable front hood with chain protection

- > Rear protection with rubber flap

- > Support roller 152 mm Ø

- > Standard rotor with Y flails

Optional configuration and accessories

- > Forestry rotor mulches brush and wood up to 12 cm [5 inch] with swinging or fixed hammers

- > 1000 rpm gearbox



www.youtube.com/seppimulcher

Specifications • S5 cabrio						
Working width	cm [inch]	125 [49]	155 [61]	175 [69]	200 [79]	225 [88]
Overall width	cm [inch]	137 [54]	167 [66]	187 [74]	212 [84]	237 [93]
Depth	cm [inch]	90 [35]	90 [35]	90 [35]	90 [35]	90 [35]
Height	cm [inch]	105 [41]	105 [41]	105 [41]	105 [41]	105 [41]
Weight (base value)	kg [lb]	380 [840]	425 [940]	480 [1,060]	540 [1,190]	610 [1,350]
Belts	qty	4	4	4	4	4
Y flails	qty	24	27	33	39	45
Swinging hammers	qty	21	26	29	-	-
Fixed hammers	qty	27	33	-	-	-
Nominal tractor power	HP	30-90	30-90	40-90	50-90	50-90

Tools

- Flails
Y DUO

- Swinging hammers
FORST

- Fixed hammers
MINI-DUO

S5 cabrio · features

Robust double wall chassis made of high tensile and wear resistant steel AR400.

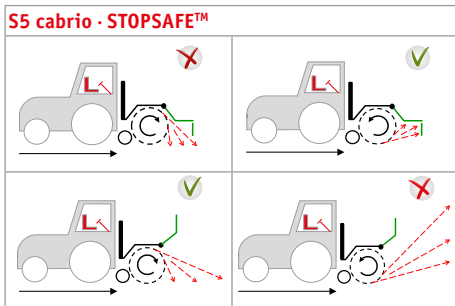

The STOPSAFE™ system for S5 cabrio avoids improper use of the machine. The system switches off the rotation if the rotor runs upwards and the hood is being opened. At the same time, if the hood is open it prevents the selection of the upward rotor direction.

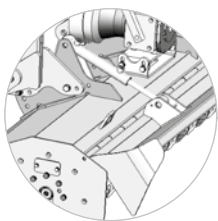

Wide-open hydraulic front hood to mulch high grass

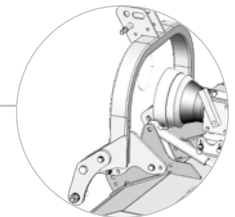

Linkage frame suitable for most current implement carriers and for tractors with reverse drive

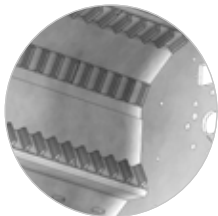

Tempered counter knives for a perfect mulching result

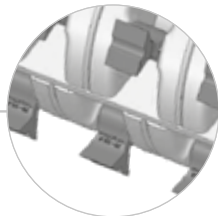

Optional forestry rotor with swinging hammers

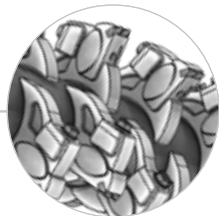

Optional forestry rotor with fixed hammers

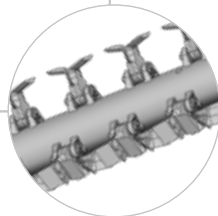

Standard rotor with Y flails



Adjustable roller, Reinforced bearing and roller- Large diameter roller allows mulching on uneven ground

SMW0

30-90 HP Ø max. 5 cm [2 inch]

Mulcher with generous side shift

Agriculture or greenspace maintenance? All easy ...

– the mulchers of the SMW series mulch grass, prunings and bushes up to 5 cm [2"] in diameter.

The model SMW0 is distinguished by an extraordinarily wide side shift to the right. The parallel linkage system allows the machines to work under the trees and close to the crop leaving a much cleaner result.

Standard version and characteristics

- > Mulches grass and brush up to 5 cm [2"] Ø
- > Working speed 3-10 km/h
- > 3 point rear linkage cat. 1&2
- > Manual parallel linkage side shift
- > 540 rpm gearbox with freewheel and through shaft
- > Belt transmission
- > Adjustable rear hood with rubber protection
- > Front protection with metal flaps
- > Support roller 152 mm Ø
- > Standard rotor with SMW flails

Optional configuration and accessories

- > Rotor with Y flails
- > 1000 rpm gearbox
- > Reinforced transmission
- > Hydraulic side shift
- > Hood with rakes
- > Metal front wheels
- > Front protection with chains instead of metal flaps
- > Additional front rubber flap
- > Attachments for undercanopy maintenance (details see separate brochure)



www.youtube.com/seppimulcher

Tools



Specifications · SMW0

Working width	cm [inch]	135 [53]	145 [57]	155 [61]	175 [69]	200 [79]
Overall width	cm [inch]	147 [58]	157 [62]	167 [66]	187 [74]	212 [83]
Depth	cm [inch]	120 [47]	120 [47]	120 [47]	120 [47]	120 [47]
Height	cm [inch]	95 [37]	95 [37]	95 [37]	95 [37]	95 [37]
Weight (base value)	kg [lb]	410 [900]	430 [940]	445 [980]	495 [1,090]	520 [1,140]
Belts	qty	3	3	3	4	4
Flails	qty	12	15	15	18	21
Y flails	qty	24	27	27	33	39
Nominal tractor power	HP	30-65	30-65	30-65	40-90	40-90



SMWO · features

Robust double wall chassis made of high tensile steel S420.

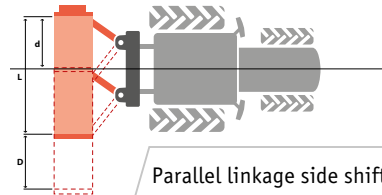

Parallel linkage side shift

L	d	D
135-150	73 cm [29"]	62 cm [24"]
155-200	82 cm [32"]	62 cm [24"]

Rake hood complete with rakes (option)

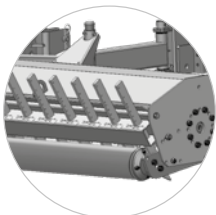

Adjustable hood to set the degree of mulching

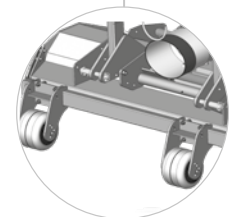
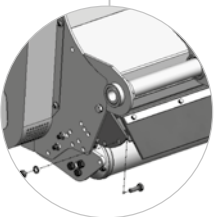

Metal front wheels (option)



Standard rotor with SMW flails

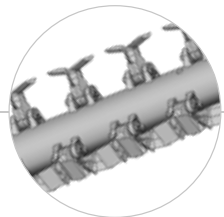

Optional rotor with Y flails



Tempered counter knives for a perfect mulching result



SMO

50-120 HP Ø max. 7 cm [2.8 inch]

The expert among the lightweight mulchers with parallel linkage side shift

Road sides, meadows, pastures – the SMO machines satisfy the needs of professionals in the most varied situations with an even clean cut.

The machines of this series mulch grass and brushwood up to 7 cm in diameter.

The model **SMO** is distinguished by an extraordinarily wide side shift to the right. The standard version is equipped with manual side shift, hydraulic side shift is optional. Total side shift is 73 cm [28.7"].

As an option it is also available with central position and side shift to both sides.

Standard version and characteristics

- > Mulches grass and brush up to 7 cm [2.8"]Ø
- > Working speed 3-10 km/h
- > 3 point rear linkage
≤225: cat. 1&2, ≥250: cat. 2
- > Manual parallel linkage side shift central/right
- > Gearbox with freewheel and through shaft
≤200: 540 rpm, ≥225: 1000 rpm
- > Belt transmission
- > Adjustable rear hood with rubber protection
- > Front protection with metal flaps
- > Support roller 152 mm Ø
- > Standard rotor with flails
≤200: SMO, ≥225: SMW

Optional configuration and accessories

- > Rotor with Y flails
- > 540 or 1000 rpm gearbox
- > Hydraulic side shift
- > Side shift central/left
- > Hood with rakes
- > Front protection with chains instead of metal flaps
- > Additional front rubber flap
- > Metal front wheels
- > Rubber wheels instead of roller
- > Attachments for undercanopy maintenance (details see separate brochure)



[YouTube www.youtube.com/seppimulcher](https://www.youtube.com/seppimulcher)

Tools

SMW

SMO



Specifications · SMO

		125 [49]	150 [59]	175 [69]	200 [79]	225 [89]	250 [98]
Working width	cm [inch]	125 [49]	150 [59]	175 [69]	200 [79]	225 [89]	250 [98]
Overall width	cm [inch]	140 [55]	165 [65]	190 [75]	215 [85]	240 [95]	265 [100]
Depth	cm [inch]	120 [47]	120 [47]	120 [47]	120 [47]	120 [47]	120 [47]
Height	cm [inch]	120 [47]	120 [47]	120 [47]	120 [47]	120 [47]	120 [47]
Weight (base value)	kg [lb]	470 [1,030]	500 [1,100]	550 [1,210]	600 [1,320]	660 [1,450]	720 [1,590]
Belts	qty	4	4	4	4	5	5
Flails	qty	12	15	18	21	24	27
Y flails	qty	24	27	33	39	45	x
Nominal tractor power	HP	50-100	50-100	50-100	50-100	50-120	50-120

SMO · features

Robust double wall chassis made of high tensile steel S420.



Parallel linkage side shift

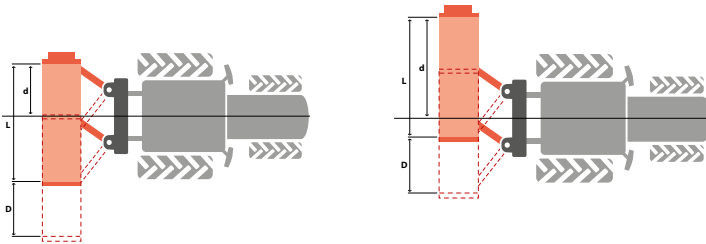

Standard: central/right
d = 69 cm [27 inch]
D = 73 cm [73 inch]

Option: central/left
d = 131 cm [29 inch]
D = 73 cm [24 inch]

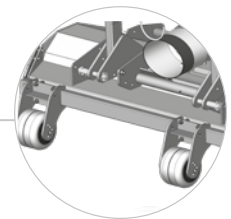

Metal front wheels (option)

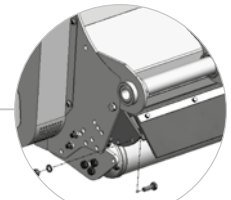

Adjustable hood to set the degree of mulching

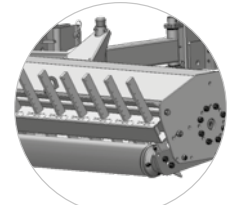

Rake hood complete with rakes (option)



Adjustable support roller, Reinforced bearing and roller

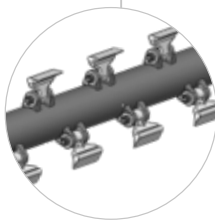

Standard rotor with SMW/SMO flails

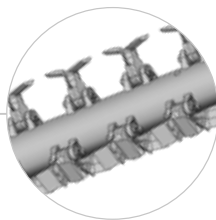

Optional rotor with Y flails

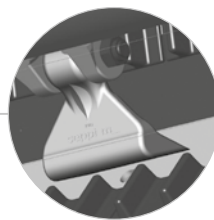

Tempered counter knives for a perfect mulching result

SMO rev cf

50-120 HP Ø max. 7 cm [2.8 inch]

The expert among the lightweight mulchers with reversible linkage

Road sides, meadows, pastures – the SMO machines satisfy the needs of professionals in the most varied situations with an even clean cut.

The machines of this series mulch grass and brushwood up to 7 cm in diameter.

The model **SMO rev cf** has a central 3-point linkage. The mulcher is reversible and can be driven in both direction - front and rear.

Standard version and characteristics

- > Mulches grass and brush up to 7 cm [2.8"]Ø
- > Working speed 3-10 km/h
- > 3 point linkage cat. 2 reversible
- > 1000 rpm gearbox with freewheel and through shaft
- > Belt transmission
- > Adjustable rear hood with rubber protection
- > Front protection with metal flaps
- > Support roller 152 mm Ø
- > Standard rotor with SMO flails

Optional configuration and accessories

- > Rotor with Y flails
- > 540 rpm gearbox
- > Gearbox with automatic inverter and double freewheel
- > Additional 3-point linkage
- > Front attachment
- > Hood with rakes
- > Front protection with chains instead of metal flaps
- > Additional front rubber flap
- > Metal front wheels
- > Rubber wheels instead of roller
- > Attachments for undercanopy maintenance (details see separate brochure)



www.youtube.com/seppimulcher

Tools



Specifications • SMO rev cf

		150 [59]	175 [69]	200 [79]	225 [89]	250 [98]
Working width	cm [inch]	150 [59]	175 [69]	200 [79]	225 [89]	250 [98]
Overall width	cm [inch]	165 [65]	190 [75]	215 [85]	240 [95]	265 [100]
Depth	cm [inch]	120 [47]	120 [47]	120 [47]	120 [47]	120 [47]
Height	cm [inch]	120 [47]	120 [47]	120 [47]	120 [47]	120 [47]
Weight (base value)	kg [lb]	480 [1,050]	550 [1,210]	600 [1,310]	650 [1,430]	710 [1,560]
Belts	qty	4	4	4	5	5
Flails	qty	15	18	21	24	27
Y flails	qty	27	33	39	45	x
Nominal tractor power	HP	50-100	50-100	50-100	50-120	50-120

S420 rev cf · features

Robust double wall chassis made of high tensile steel S420.

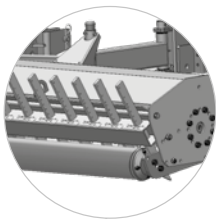

Rake hood complete with rakes (option)



Gearbox for front and rear attachment

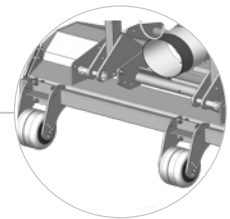

Metal front wheels (option)

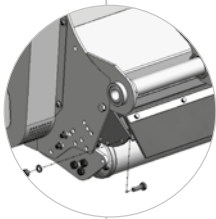

Adjustable hood to set the degree of mulching



Adjustable support roller, Reinforced bearing and roller

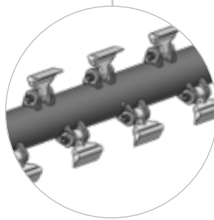

Standard rotor with SMO flails

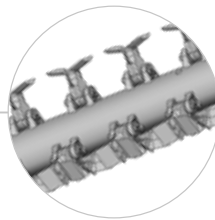

Optional rotor with Y flails

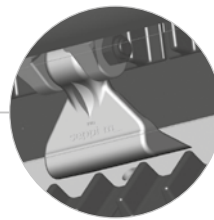

Tempered counter knives for a perfect mulching result

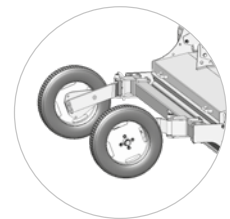

Rubber gauge wheels for uneven ground (instead of roller)

SMO fh

50-120 HP Ø max. 7 cm [2.8 inch]

The expert among the lightweight mulchers with innovative linkage

Road sides, meadows, pastures – the SMO machines satisfy the needs of professionals in the most varied situations with an even clean cut.

The machines of this series mulch grass and brushwood up to 7 cm in diameter.

The **SMO fh** is characterized by an innovative, pyramid-shaped 3-point linkage, suitable for front and rear attachment. The top link connection provides high stability and is easily reversed to allow front or rear mount to be achieved without heavy lifting.

Standard version and characteristics

- > Mulches grass and brush up to 7 cm [2.8"]Ø
- > Working speed 3-10 km/h
- > 3 point linkage cat. 2 reversible
- > Linear hydraulic side shift
L150-175: 33 cm [13 inch] or
L200-275: 55 cm [21.6 inch]
- > 1000 rpm gearbox with freewheel and through shaft
- > Belt transmission
- > Adjustable rear hood with rubber protection
- > Front protection with metal flaps
- > Support roller 152 mm Ø
- > Standard rotor with SMO flails

Optional configuration and accessories

- > Rotor with Y flails
- > 540 rpm gearbox
- > Gearbox with automatic inverter and double freewheel
- > Metal front wheels
- > Front protection with chains instead of metal flaps
- > Rubber wheels instead of roller
- > Additional front rubber flap



[YouTube www.youtube.com/seppimulcher](https://www.youtube.com/seppimulcher)

Tools



Specifications · SMO fh

		150 [59]	175 [69]	200 [79]	225 [89]	250 [98]	275 [108]
Working width	cm [inch]	150 [59]	175 [69]	200 [79]	225 [89]	250 [98]	275 [108]
Overall width	cm [inch]	165 [65]	190 [75]	215 [85]	240 [95]	265 [105]	280 [115]
Depth	cm [inch]	130 [51]	130 [51]	130 [51]	130 [51]	130 [51]	130 [51]
Height	cm [inch]	120 [47]	120 [47]	120 [47]	120 [47]	120 [47]	120 [47]
Weight (base value)	kg [lb]	660 [1,455]	730 [1,610]	790 [1,740]	850 [1,870]	930 [2,050]	1.020 [2,250]
Belts	qty	4	4	4	5	5	5
Flails	qty	15	18	21	24	27	27
Y flails	qty	27	33	39	45	x	x
Nominal tractor power	HP	50-100	50-100	50-100	50-120	50-120	50-120

SMO fh · features

Robust double wall chassis made of high tensile steel S420.



Innovative, pyramid-shaped 3-point linkage with high stability, suitable for front and rear attachment

Linear hydraulic side shift

model	each side	total
150-175	16.5 cm [6.5"]	33 cm [13"]
155-200	27.5 cm [10.8"]	55 cm [21.6"]

Gearbox for front- and rear attachment

Adjustable hood to set the degree of mulching

Adjustable support roller, Reinforced bearing and roller

Tempered counter knives for a perfect mulching result

Optional rotor with Y flails

Standard rotor with SMO flails

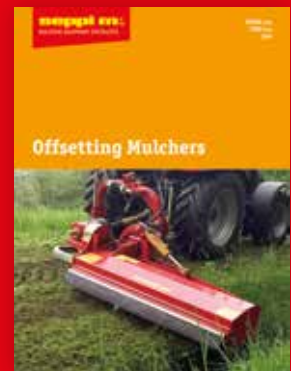
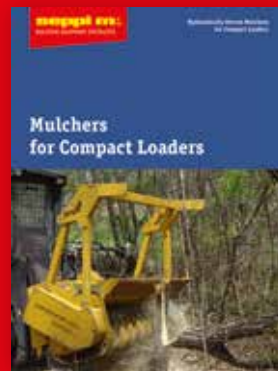
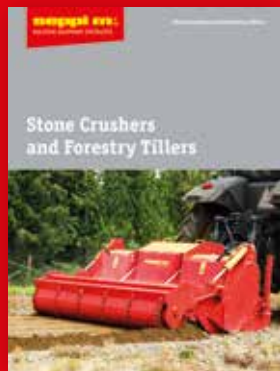
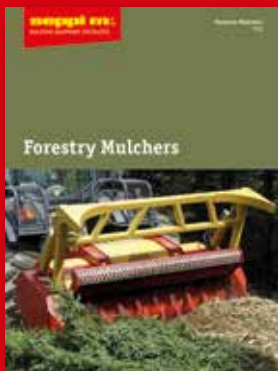
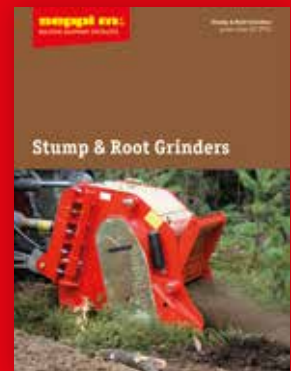
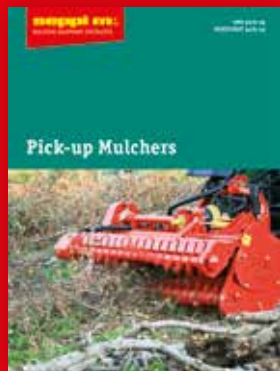
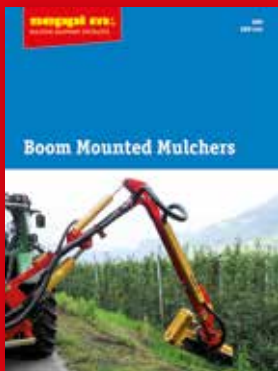
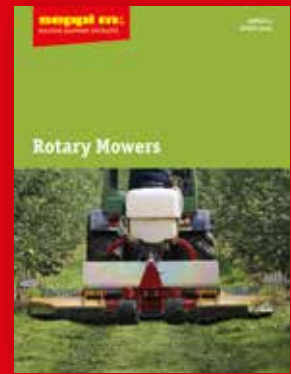
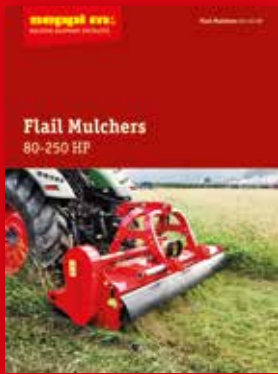

SEPPi M. SpA/AG Italy
 Zona Artigianale 1 Handwerkerzone
 I-39052 Caldaro/Kaltern (BZ)
www.seppi.com

SEPPi M. USA
 Division of SEPPi M. SpA
 9077 Gold Park Drive
 West Chester, OH 45011

www.youtube.com/seppimulcher

